

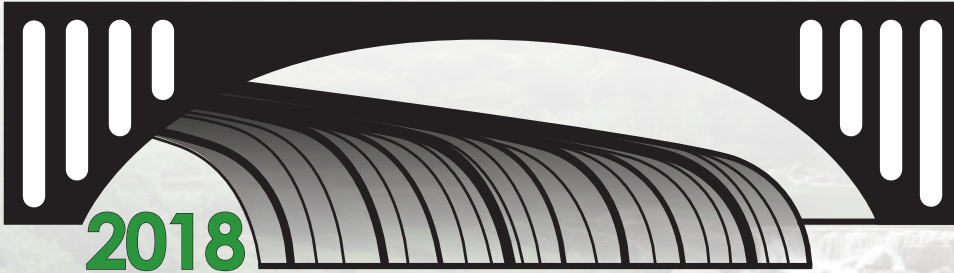

# RIDING the RAPIDS of CHANGE



**APA Washington Annual Conference**

**OCTOBER 4-5, 2018**

**DoubleTree by Hilton  
Spokane City Center  
Spokane, WA**

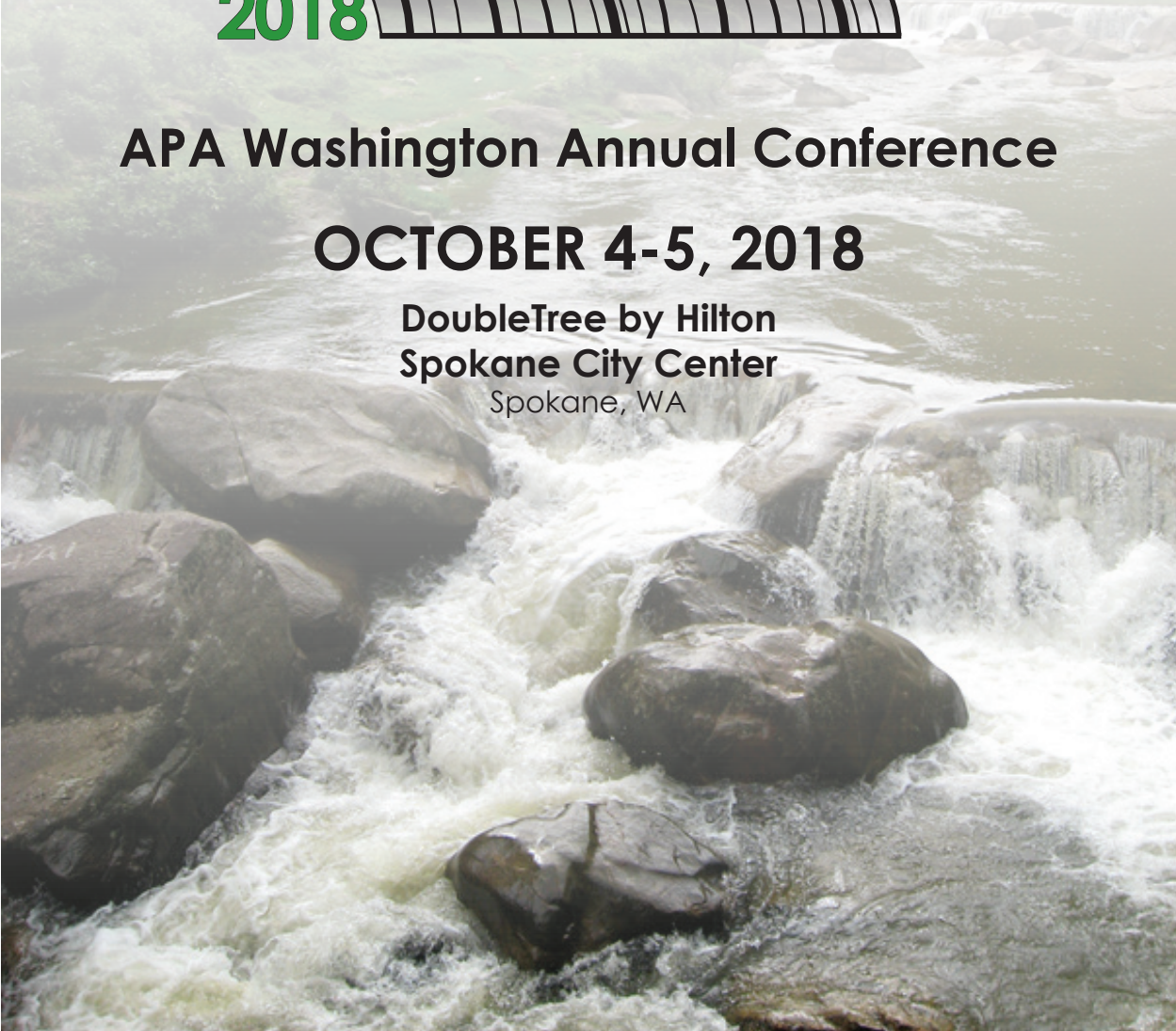



# WA APA Board of Directors

## Executive Board

President	Rick Sepler, AICP
Vice President	Elizabeth Chamberlain, AICP
Past President	Paula Reeves, AICP CTP
Secretary	Nikole Coleman, AICP
Treasurer	Al Torrico
Columbia Section	Ardele Steele, AICP, CFM
Inland Empire Section	David Andersen, AICP
Northwest Section	Chris Comeau, AICP
Peninsula Section	Judy Surber
Puget Sound Section	Cristina Barone
Southwest Section	Sarah Fox, AICP
South Sound Section	Grant Beck

## Conference Committee

Dave Andersen, AICP, Co-Chair, WA State Dept of Commerce
Shauna Harshman, Co-Chair, City of Spokane
Robert Brock, AICP, Spokane County
Nikole Coleman, AICP, City of Poulsbo
Donna deBit, City of Spokane
Nancy Eklund, AICP, Boeing
Sabrina Minshall, AICP, Spokane Regional Transportation Council

## Standing Committees

National Conference	Paul Inghram AICP Deborah Munkberg AICP
Awards	Darby Cowles, AICP
Communications	Nikole Coleman, AICP Dinah Reed, AICP
Community Planning Assistance Team	Bob Bengford, AICP Patrick Lynch, AICP
Continuing Education	Ferdouse Oneza, AICP
Legislative Action	Yorik Stevens-Wajda Esther Larsen
Membership	Geoff Appel, AICP Talia Tiffelfitz, AICP
Planning Official Development Officer	Ryan Windish, AICP
Professional Development Officer	Nancy Eklund, AICP
Scholarship	Wells Williams, AICP Kirk Rappe
Tribal Planning	Michael Cardwell, AICP
UW Student Representative	Sarah Wallace
EWU Student Representative	Anthony Taylor

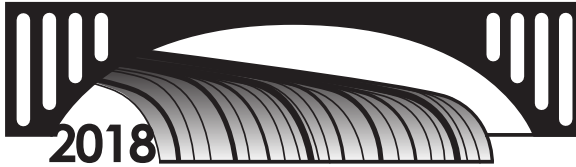

## Table of Contents

WA APA Board of Directors.....	Inside Front
Conference Committee .....	Inside Front
Certification Maintenance .....	1
Conference Schedule at a Glance .....	2-3
Keynote Speakers .....	4
Hotel Maps.....	5
Conference Sessions.....	6-15
Notes .....	15
2018 Planning Awards .....	16
AICP Exam .....	Inside Back
Sponsors .....	Back



### Certification Maintenance

#### How can I earn CM credits?

The American Planning Association (APA) ([www.planning.com](http://www.planning.com)) and the Washington Chapter ([www.washington-apa.org](http://www.washington-apa.org)) have extensive information on activities that qualify for CM credit. CM credit hours requested for sessions at this conference are pending.

#### How can I log CM credits?

Every AICP member has a personal online CM log. Use your APA ID and password to log in at [www.planning.org](http://www.planning.org), search for CM activities, rate them, and submit them to your CM log. CM credit has been requested for the majority of workshops and sessions at this conference unless noted. If you have questions, please contact APA at [aicpcm@planning.org](mailto:aicpcm@planning.org).

## WEDNESDAY, OCTOBER 3

4:00 pm	7:00 pm	<b>WA APA Board of Directors Meeting</b> (Spokane Falls A/B)
6:15 pm	9:15 pm	<b>SHORT COURSE on Local Planning</b> (Grand Ballroom, Salon II & III)
7:00 pm	9:00 pm	<b>A Night at the Terrain Art Exhibit</b>

## THURSDAY, OCTOBER 4

		<b>Finding the Balance (Sustainability)</b>	<b>Recharging Our Communities (Community Development)</b>	<b>Outfitting the Planner (Toolbox)</b>	<b>Uncharted Waters (Leading Edge)</b>	<b>Community Engagement</b>	
6:30 am	7:30 am	<b>EARLY MORNING RUN/WALK</b> (Meet in the DoubleTree Lobby)					
7:30 am	8:30 am	<b>REGISTRATION, EXHIBITS AND NETWORKING</b> (Grand Ballroom Foyer)					
8:30 am	8:50 am	<b>Welcome to Spokane! Greetings from APA Washington President</b> (Grand Ballroom, Salon IV & V)					
8:50 am	10:00 am	<b>OPENING SESSION with Governor Paris Glendenning</b> (Grand Ballroom, Salon IV & V)					
10:00 am	10:15 am	<b>BREAK WITH EXHIBITORS</b> (Grand Ballroom Foyer)					
10:15 am	11:15 am	Optimizing Drinking Water for Growth (Spokane Falls C/D)	Paddling Back to Strong Downtowns (Spokane Falls A/B)	What's Next? Making an Age-Friendly Workplan Work (GB, Salon I)	Black Rock City Lessons in the Dust (GB, Salon II)	Race Matters: Striving for Equitable Outcomes (GB, Salon III)	
11:15 am	11:30 am	<b>BREAK WITH EXHIBITORS</b> (Grand Ballroom Foyer)					
11:30 am	12:30 pm	Climate Adaptation Through Local Comprehensive Planning (aka Planning to be Resilient) (Spokane Falls C/D)	Downtown Sandpoint Revitalized: Planned and Implemented (GB, Salon I)	What's Mapping!?! GIS for Planners (GB, Salon II)	Great Civic Spaces as Catalysts for Creating Livable Communities (Spokane Falls A/B)	Engaging the Community to Reinvent Autocentric Neighborhoods (GB, Salon III)	
12:40 pm	1:50 pm	<b>LUNCH AND KEYNOTE SPEAKER – Planning Through the Back Door</b> Steve Smith, author and tour guide for Rick Steves Travel (Grand Ballroom, Salon IV & V)					
2:00 pm	3:15 pm	Replumbing Spokane Falls (Spokane Falls C/D)	Riding to Bicycle Mobility (GB, Salon I)	The Changing Workplace Culture – Thriving vs. Surviving (Spokane Falls A/B)	Local Regulation of the Cannabis Industry Through the Eyes of a Land Use Planner Turned Cannabis Farmer (GB, Salon II)	Engaging Youth – Make it Happen! (GB, Salon III)	
3:15 pm	3:30 pm	FAICP-Sponsored Session: Ethics for Planners and Our Allied Professions (Ethics CM) (Spokane Falls A/B)	<b>BREAK WITH EXHIBITORS</b> (Grand Ballroom Foyer)			<b>SPOKANE HERITAGE WALK</b> (3:15 - 5:00 pm) Discover the unique history, charm and diversity of downtown Spokane. (Meet at Reg. Desk)	
3:30 pm	4:45 pm		Bus Rapid Transit: Reconnecting our Communities (GB, Salon I)	Using Needs Assessments to Help Communities Thrive (GB, Salon II)	At the Intersection of Planning and Public Health – The State of the Art (GB, Salon III)		
5:15 pm	7:00 pm	<b>RECEPTION AT SPOKANE LIBRARY</b> (906 West Main Avenue, Spokane, WA 99201) Sponsored in part by BHC Consultants, LLC • BergerABAM • BERK Consulting					
7:00 pm		<b>PUB CRAWL</b> (See flyer at Registration Desk)					

# Schedule-at-a-Glance

## FRIDAY, OCTOBER 5

		Finding the Balance (Sustainability)	Recharging Our Communities (Community Development)	Outfitting the Planner (Toolbox)	Uncharted Waters (Leading Edge)	Community Engagement	
6:30 am	7:30 am	<b>EARLY MORNING RUN/WALK</b> (Meet in the DoubleTree Lobby)					
7:30 am	8:30 am	<b>REGISTRATION, EXHIBITS AND NETWORKING</b> (Grand Ballroom Foyer)					
8:30 am	9:45 am		A Leading-Edge Approach to Riding the Affordable Housing Wave (GB, Salon I)	The Ethics of How We Plan and Design Streets (Ethics CM) (Spokane Falls A/B)	Community Planning in the ROW (GB, Salon II)	Inspiring Your Community and Invigorating Your Economy Through Art & Placemaking (GB, Salon III)	
9:45 am	10:00 am	<b>BREAK WITH EXHIBITORS</b> (Grand Ballroom Foyer)	<b>SPOKANE RIVER WALKING TOUR</b> (9:45 - 12:00 pm) An exploration of riverfront history, redevelopment, Riverfront Park, Brownfields, and tribal significance. (Meet at Reg. Desk)		<b>BREAK WITH EXHIBITORS</b> (Grand Ballroom Foyer)		
10:00 am	11:00 am	SMPs: Yesterday, Today, and Tomorrow (GB, Salon I)		Reimagining Riverfront Park (GB, Salon II)	Right Size Parking Code Reform (Spokane Falls A/B)	Engaging Mercer Island on Residential Development Standards (GB, Salon III)	
11:00 am	11:15 am	<b>BREAK WITH EXHIBITORS</b> (Grand Ballroom Foyer)		<b>BREAK WITH EXHIBITORS</b> (Grand Ballroom Foyer)			
11:15 am	12:00 pm	Intergovernmental Watershed Planning to Recover Salmon (GB, Salon I)		LAMIRDS: Comparing County Experiences (Spokane Falls A/B)	Minimizing the Attack Surface: Techniques for Land Use Planning Borrowed From Computer Science (GB, Salon III)		
12:10 pm	1:30 pm	<b>LUNCH, ANNUAL MEETING AND AWARDS PROGRAM</b> (Grand Ballroom, Salon IV & V)					
1:45 pm	3:00 pm	Intro to Tribal Law for Planners (Law CM) (GB, Salon III)	Baby Steps to Vision Zero (GB, Salon I)	Navigating Tricky Councils (Spokane Falls A/B)	New Rules for Schools: School Siting Challenges and Creative Solutions (GB, Salon II)	<b>LIFE IN THE HEART OF THE RAPIDS</b> (1:45 - 4:30 pm) A walking tour of downtown Spokane housing, from historic Single Room Occupancy workforce housing to mixed-use buildings with luxury apartments. (Meet at Reg. Desk)	
3:00 pm	3:30 pm	<b>BREAK AND EXHIBITS</b> (Grand Ballroom Foyer)					
3:30 pm	4:30 pm	Buildable Lands & Land Capacity Analysis: What's the Connection (Spokane Falls A/B)	Blue Mountain Region Trails Plan – A Regional Interconnected Non-Motorized Network (GB, Salon I)	Planning for Spokane's South University District (GB, Salon II)			
6:00 pm		<b>EWU Planning Program 50th Anniversary Celebration</b> (Grand Ballroom, Salon V)					



# Keynote Speakers



## Governor Parris Glendening Smart Growth Strategies and Managing Change

Our country is experiencing immense changes — the physical places we live, the people who live there, and the politics that govern them. Governor Parris Glendening will discuss several of these shifts and how they are pushing us towards more walkable, smart growth.

Governor Parris N. Glendening is President of Smart Growth America's Leadership Institute and the Governors' Institute on Community Design. In these roles, Glendening speaks across the country and around the world about smart growth, sustainability, global climate change, land conservation, transit oriented development, and equity. He regularly speaks to environmental advocacy groups, business leaders and professional organizations.

Parris Glendening served as Governor of Maryland (1995-2003) where he created the nation's first state level smart growth program for which he received Harvard University's Innovations in American Government Award.



## Steve Smith Planning Through the Back Door

What is it that creates the distinct sense of place experienced in Europe? How can we as planners reimagine public spaces that become the soul of our communities?

Steve Smith expounds on his journey from a career that began as a community planner and morphed into that of a travel book author and tour guide spanning more than 30 years with *Europe Through the Back Door*.

Steve will offer perspectives and observations of great places and lessons learned from his adventures in Europe. The discussion will include practices to consider in creating high-quality, livable communities that are adaptable to cities, towns, and villages.

Steve Smith is best known as Rick's France tour guide in several episodes of *Rick Steves' Europe* on public television, and as the co-author of Rick's; *France, Provence and the French Riviera* and *Paris* guidebooks. His love for the farmhouse he and his wife renovated in Burgundy — where he hangs his beret in research season — is rivaled only by his passion for Volkswagen Westphalia campers. Steve spends his spring and summers researching his guidebooks. Until his recent retirement, Steve also managed the hiring and training for over 150 guides for Rick Steves tours, helping send tens of thousands of happy travelers to Europe each year. Steve has a Master's Degree in Urban Planning from the University of Washington, and worked as a planner for King County and Washington State Department of Transportation prior to joining *Rick Steves' Europe*.

# Hotel Maps

## MAIN LEVEL

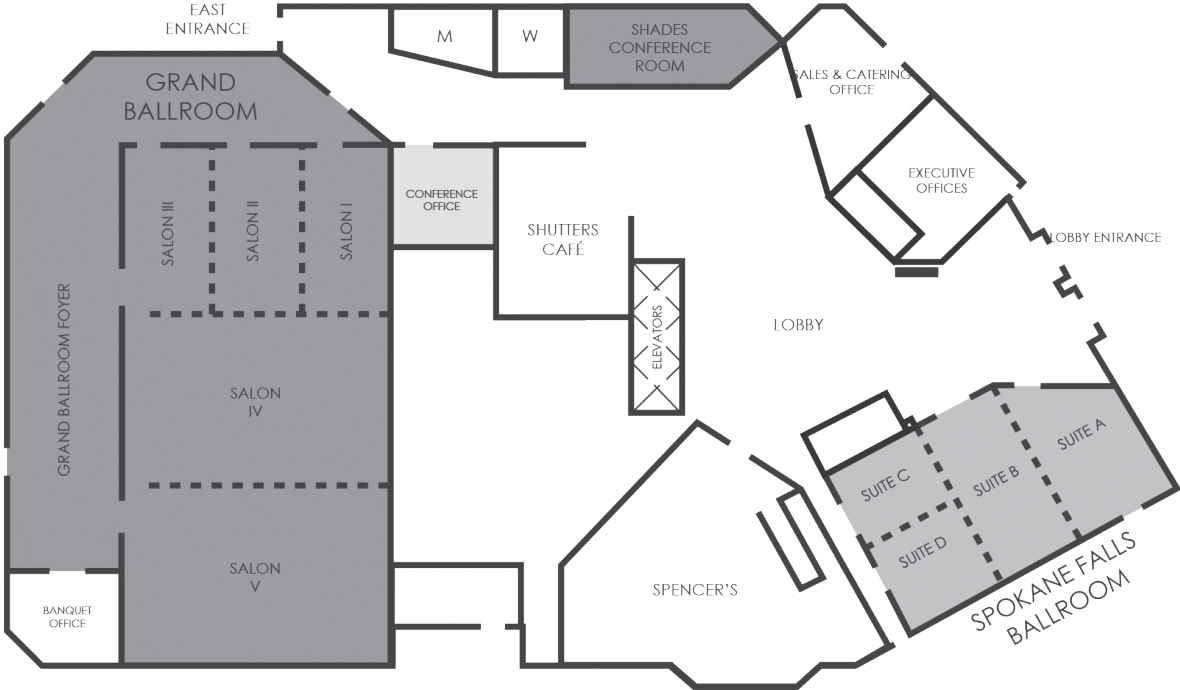

Wi-Fi sponsored by: FEHR & PEERS

Network: DoubleTree Meeting

Password: FehrPeers

# Conference Sessions

## WEDNESDAY, OCTOBER 3, 2018

**4:00 pm – 7:00 pm**

WA APA Board of Directors Meeting

Spokane Falls A/B

**6:15 pm – 9:15 pm**

Short Course on Local Planning

Grand Ballroom, Salon II & III

**7:00 pm – 9:00 pm**

A Night at the Terrain Art Exhibit

## THURSDAY, OCTOBER 4, 2018

**6:30 am – 7:30 am**

Early Morning Run or Walk

Meet in the DoubleTree Lobby

**7:30 am – 8:30 am**

REGISTRATION, EXHIBITS & NETWORKING

Grand Ballroom, Foyer

**8:30 am – 10:00 am**

Welcome to Spokane and Opening Session

SPEAKER: Governor Parris Glendening

Grand Ballroom, Salon IV & V

**10:00 am – 10:15 am**

BREAK & EXHIBITS

Grand Ballroom, Foyer

**10:15 am – 11:15 am**

Optimizing Drinking Water for Growth

SPEAKERS: Debroah Johnson, WA State Dept of Health • Brian Sayers, WA State Dept of Health • Benjamin Serr, WA State Dept of Commerce

Drinking water plays a critical role in planning for all (both fully & partially planning) Washington communities. This session focuses on how water availability, quantity, and quality; critical aquifer recharge area protection; future service areas; and system capacity affect local planning activities and zoning administration.

Spokane Falls C/D..... 1 CM

Paddling Back to Strong Downtowns

MODERATOR: Brian Scott, PhD, BDS Planning and Urban Design

SPEAKERS: Melissa Owen, City of Spokane • RJ Keetch, City of Colville • John Collum, AICP, City of Vancouver, WA

Main Streets are experiencing a renaissance of revitalization, as leaders and planners build partnerships and improve on existing strengths to create vibrant corridors of retail, restaurants, cultural experiences and unique local businesses. Hear the success stories from several Washington cities that have reinvested in their downtowns and neighborhood commercial districts.

Spokane Falls A/B..... 1 CM



## What's Next? Making an Age-Friendly Workplan Work

MODERATOR: Carol Kachadoorian, Toole Design Group

SPEAKERS: Brent Butler, CFM, City of Seattle • Lizzie Moll, City of Seattle

People can age with ease in an age-friendly city. Working with AARP and stakeholders for 15 months, Seattle's Age-friendly Task Force developed a workplan that was adopted by the City. Learn how the Task Force is implementing its workplan from members of its Transportation and Public Space Committee.

Grand Ballroom, Salon I..... 1 CM

## Black Rock City Lessons in the Dust

SPEAKER: Omar Akkari, PLA, City of Spokane

Black Rock City rises from the dust for a weeklong festival and celebration of art, music, and dance known as Burning Man. This presentation will discuss the guiding principles of the temporary city and how aspects of the event might be applied to enrich more permanent settlements.

Grand Ballroom, Salon II..... 1 CM

## Race Matters: Striving for Equitable Outcomes

MODERATOR: Manal Al-ansi, Seattle Department of Transportation

SPEAKERS: Ubox Gardheere, City of Seattle • Mikel Davila, City of Seattle • Chisaki Muraki, Seattle Department of Transportation

The Race and Social Justice Initiative started at the City of Seattle more than a decade ago, focuses on dismantling institutional racism, and provides a framework for the work we do. Hear about the tools and methods used with business districts, for a transportation planning study, and the equitable Development Initiative.

Grand Ballroom, Salon III..... 1 CM

## 11:15 am – 11:30 am

## BREAK & EXHIBITS

Grand Ballroom, Foyer

## 11:30 am – 12:30 pm

## Climate Adaptation through Local Comprehensive Planning (aka Planning to be Resilient)

SPEAKERS: Stacey Justus Nordgren, MA, Foresight Partners Consulting • Lara Hansen, PhD, EcoAdapt • Gary Idleburg, WA State Dept of Commerce

EcoAdapt and Foresight Partners Consulting, with funding from the Bullitt Foundation and Bainbridge Island Community Foundation, have been working to develop a suite of climate adaptation planning and implementation tools applicable for Washington state, and with transferability nation-wide. This session will explain their work to date that has been focused in the Puget Sound region: first at the local scale (partnering with Bainbridge Island as a case study of incorporating climate into their 2016 Comprehensive Plan update); then at the regional scale (creating Guidance for Puget Sound communities); and now again at the regional scale (where they are creating implementation tools that were conceived of in the Puget Sound Guidance document – in particular, the development of a Climate Change Adaptation Certification process). This CCAC will be completed by the time of this conference and will be presented as a "ready to go" implementation tool.

Spokane Falls C/D..... 1 CM

## Downtown Sandpoint Revitalized: Planned and Implemented

SPEAKERS: Aaron Qualls, City of Sandpoint

A Community vision spanning almost two decades, the Downtown Sandpoint two-way streets conversion and revitalization project has involved many different players over the years and incorporates several planning related themes including public outreach, transportation, place-making, tactical urbanism, economic development, parking, storm water management and urban design.

Grand Ballroom, Salon I..... 1 CM

## What's Mappening!?

### GIS for Planners

**SPEAKERS:** Sam Rubin, AICP, BergerABAM • Allison Kinney, BergerABAM • Sam Jones, BergerABAM

A scientist, a planner, and a landscape designer walk into a room and talk about how they use GIS. This panel discussion will provide some tips, tricks, and tools for planners with all levels of GIS experience.

Grand Ballroom, Salon II..... 1 CM

## Great Civic Spaces as Catalysts for Creating Livable Communities

**MODERATOR:** Steve Butler, FAICP, MRSC

**SPEAKERS:** Arun Jain, FAICP • Guy Michaelsen, Berger Partnership

Well-planned public spaces are critical assets that contribute greatly to a community's vitality and health. Yet these public spaces are difficult to acquire, finance, design, and maintain. This session will explore design and non-design attributes are most important to a public space's success, and provide several case studies.

Spokane Falls A/B..... 1 CM

## Engaging the Community to Reinvent Autocentric Neighborhoods

**MODERATOR:** Ariel Davis, AICP, Fehr & Peers

**SPEAKERS:** Thara Johnson, City of Burien • Daren Crabill, NBBJ • Katrina Knutson, AICP, City of Gig Harbor

Many communities are looking to become more vibrant places to live, but are defined by their busy arterials and struggle to balance differing visions for the future. This session will share the stories of three communities who have addressed these challenges through innovative planning processes and community engagement.

Grand Ballroom, Salon III..... 1 CM

## 12:40 pm – 1:50 pm

### KEYNOTE LUNCH

Grand Ballroom, Salon IV & V

## 2:00 pm – 3:15 pm

### Replumbing Spokane Falls: Finding a Balance

**SPEAKERS:** Mark Greening, SCJ Alliance • Berry Ellison, City of Spokane • Speed Fitzhugh, Avista Corporation

This session and tour will explain and show how Spokane Falls in downtown Spokane were "replumbed" with stakeholder input. This process that was used to reach agreement with the stakeholders resulted in improving the appearance and sounds of the falls during low flow periods of the year (summer and fall) while conserving water for electrical power production.

Spokane Falls C/D..... 1.25 CM

### Riding to Bicycle Mobility

**MODERATOR:** Patrick Lynch, AICP, Transpo Group

**SPEAKERS:** Chris Comeau, AICP, CTP, Bellingham Public Works • Stephen Padua, AICP, City of Kirkland • Katherine Miller, PE, City of Spokane

Come see how Bellingham, Spokane, and Kirkland are retrofitting their 20th century auto-oriented transportation systems to meet 21st century multimodal mobility needs with arterial road diets removing auto lanes in favor of bike lanes, neighborhood greenways – bike boulevards on low-volume streets, and bicycle-pedestrians bridges/overpasses over mobility barriers.

Grand Ballroom, Salon I..... 1.25 CM

---

## The Changing Workplace Culture – Thriving vs. Surviving

SPEAKERS: Amanda Tainio, Synergy Resources Consulting • Michelle Griffin, Synergy Resources Consulting

Teamwork plays a key role in the planning process. From generational differences to a lack of trust, multiple factors contribute to less than optimal teams. Participants will learn from a point-counterpoint presentation and fun interactive workshop with takeaways to start implementing actions to immediately start strengthening their workplace teams.

Spokane Falls A/B..... 1.25 CM

## Local Regulation of the Cannabis Industry Through the Eyes of a Land Use Planner Turned Cannabis Farmer

SPEAKERS: David Burns, AICP • Crystal Oliver, Washington's Finest Cannabis

This session will provide practicing planners a working familiarity with the cannabis industry. The session will give planners insight into specific issues and problems the industry is facing with local government regulation, and provide information and tools planners need to address public interest concerns in both a current and long range planning context.

Grand Ballroom, Salon II..... 1.25 CM

## Engaging Youth – Make it Happen!

SPEAKERS: Stephanie Velasco, City of Seattle • Steve Butler, FAICP, MRSC • Travis Goodard, City of Woodland • Toni Pratt, City of Bellevue

Join the Washington State Youth in Planning Taskforce to learn how to connect with local schools and encourage young people in your community to get involved in planning. Attendees will leave this session with new tools and techniques to make planning fun and accessible to youth.

Grand Ballroom, Salon III..... 1.25 CM

## 3:15 pm – 3:30 pm

### BREAK & EXHIBITS

Cascade Lobby

## 3:15 pm – 4:45 pm

### FAICP-Sponsored Session:

## Ethics for Planners and Our Allied Professions

MODERATOR: Steve Butler, FAICP, MRSC

SPEAKERS: Subir Mukerjee • Karen Wolf, FAICP, King County • Megan Clark, Esq., Etter, McMahon, Lamberson, Van Wert & Oreskovich, P.C. • Dana Cowger, PE, Varela & Associates, Inc.

Acting ethically is a key element of being a planner. But what happens when planners work with members of other allied professions, such as city managers, engineers, and lawyers? This session will explore when and why those various professions may act differently when faced with a particular ethical dilemma.

Spokane Falls A/B..... 1.5 ETHICS CM

## 3:15 pm – 5:00 pm

### MOBILE WORKSHOP

## Spokane Heritage Walk

Discover the unique history, charm and diversity of downtown Spokane.

Meet at Conference Registration Desk..... 1.5 CM

**3:30 pm – 4:45 pm**

**Bus Rapid Transit: Reconnecting our Communities**

MODERATOR: Linda Amato, AICP, Environmental Science Associates

SPEAKERS: June DeVoll, Community Transit • Karl Otterstrom, AICP, Spokane Transit Authority • Scott Peterson, C-Tran • Jessica Conquest, Environmental Science Associates

In recent years, local and regional transit agencies in Washington State have been at the forefront of planning and implementation of Bus Rapid Transit (BRT) systems. Limited funding, ability to use existing infrastructure, and dependable intercity connections have contributed to the increased interest in this form of transit. BRT can provide the benefits of rail service more quickly and at a much lower cost than rail projects, and is also more dependable than standard bus service. BRT is recharging our communities by taking a step towards solving existing transportation issues, encouraging growth and development in downtowns, and transforming the way people are getting to major employment and education centers. Come hear planners from three transit agencies describe their BRT planning efforts, existing BRT service, funding, and future expansion plans. Planning consultants will also discuss some of the challenges of fitting these facilities into communities and lessons learned through preparing NEPA and SEPA documents for BRT service.

Grand Ballroom, Salon I..... 1.25 CM

**Using Needs Assessments to Help Communities Thrive**

SPEAKERS: Radhika Nair, BERK Consulting • Erika Rhett, AICP, BERK Consulting

Learn about citywide assessments of broad community needs and focused needs such as around domestic violence, a leading cause of homelessness. Needs assessments from Sammamish and Tacoma will be shared.

Grand Ballroom, Salon II..... 1.25 CM

**At the Intersection of Planning and Public Health – The State of the Art**

MODERATOR: Paula Reeves, AICP, CTP, Washington State Department of Health

SPEAKERS: Amy Shumann, King County • Amber Lenhart, Spokane Regional Health District • Julie Walton, AICP, 3 Square Blocks

Through examples from different agencies and arenas, session participants will hear about work that is breaking new ground to create anchors and allies in advancing healthy communities and assuring health equity in decision making. Panelists will provide examples of how new health data and public input is being leveraged to help both professions meet our shared and individual goals and requirements.

Grand Ballroom, Salon III ..... 1.25 CM

**5:15 pm – 7:00 pm**

**RECEPTION AT SPOKANE LIBRARY**

906 West Main Avenue  
 Spokane, WA 99201

Sponsored in part by:



**7:00 pm**

**PUB CRAWL**

MAPS available at Registration

---

# FRIDAY, OCTOBER 5, 2018

**6:30 am – 7:30 am**

## EARLY MORNING RUN OR WALK

MEET in DoubleTree Lobby

**7:30 am – 8:30 am**

## REGISTRATION & NETWORKING

Grand Ballroom, Foyer

**8:30 am – 9:45 am**

## A Leading-Edge Approach to Riding the Affordable Housing Wave

MODERATOR: Valerie Smith, AICP, Washington State Dept of Commerce

SPEAKERS: Robert Pantley, Natural and Built Environment, LLC • Angela Rozmyn, LEED AP, Natural and Built Environment, LLC • Paul Mann, WA State Advisory Council on Historic Preservation

A Leading-Edge Approach to Riding the Affordable Housing Wave includes a focus on micro-units as a tool to move the needle on housing affordability, while providing attendees with examples of local codes, developers approach to financing, potential reuse of historic properties, and how design can expand choices for housing.

Grand Ballroom, Salon I..... 1.25 CM

## Community Planning in the ROW

MODERATOR: Katy Sounders, PLA, ASLA, LEED Green Associate, MAKERS Architecture and Urban Design

SPEAKERS: Aaron Gooze, AICP, Fehr & Peers • Celeste Gilman, WSDOT • Chisaki Muraki, MUP, City of Seattle

How can our streets help recharge communities? How can urban design practices be used to promote greater mobility? How can planners use transportation projects to address broad community concerns? A series of presentations will explore these questions and illustrate different ways to enhance mobility and multimodal access at the neighborhood-scale.

Grand Ballroom, Salon II..... 1.25 CM

## Inspiring Your Community and Invigorating Your Economy Through Art & Placemaking

MODERATOR: William Simpson, AICP, WA State Dept of Commerce

SPEAKERS: Jeff Arango, AICP, Framework • Ed Marquand, Mighty Tieton, Marquand Books • Jackie Carro, Terrian

This session examines how art and placemaking are critical components of community and economic development. Explore how public, private, and non-profit organizations have formed unique partnerships, tapped into the artistic roots of the community, and influenced the built environment. Prepare to walk away with a heightened sense of creativity.

Grand Ballroom, Salon III..... 1.25 CM

Wi-Fi sponsored by: **FEHR & PEERS**

Network: DoubleTree Meeting

Password: FehrPeers

**8:30 am – 10:00 am**

**The Ethics of How We Plan and Design Streets**

**SPEAKERS:** Michael Hintze, AICP, Toole Design Group  
 Central to our role as planners is to protect the health and welfare of people through good planning and design of communities. Over 40,000 people died on U.S. roads in 2017. This session will explore our ethical duty as planners to reduce this number and how we can be effective in doing so?

Spokane Falls A/B..... 1.5 ETHICS CM

**9:45 am – 10:00 am**

**BREAK & EXHIBITS**

Grand Ballroom, Foyer

**9:45 am – 12:00 pm**

**MOBILE WORKSHOP**

**Spokane River Walking Tour**

An exploration of riverfront history, redevelopment, Riverfront Park, Brownfields and tribal significance.

Meet at Conference Registration Desk ..... 1.5 CM

**10:00 am – 11:00 am**

**SMPs: Yesterday, Today, and Tomorrow**

**MODERATOR:** Ethan Spoo, AICP, BergerABAM

**SPEAKERS:** Tim Gates, AICP, WA State Dept of Ecology • Kell Rowen, Mason County • Steve Powers, AICP, City of Oak Harbor

Consistent with the theme of "Riding the Rapids of Change," this session will explore whether new shoreline master programs (SMPs) are achieving environmental, use, and access goals. Come find out what rapids (challenges and benefits) are flowing toward local jurisdictions in the next round of SMP updates.

Grand Ballroom, Salon I..... 1 CM

**Reimagining Riverfront Park**

**SPEAKERS:** Guy Michaelsen, PLA, ASLA, Berger Partnership • Garrett Jones, PLA, ASLA, Spokane Parks and Recreation

Learn how Spokane's Riverfront Park, once home to Expo '74, is being reimagined through over 65 million dollars of investment and new programming to assure it serves the community for generations to come.

Grand Ballroom, Salon II..... 1 CM

**Right Size Parking Code Reform**

Spokane Falls, A/B..... 1 CM

**Engaging Mercer Island on Residential Development Standards**

**SPEAKERS:** Evan Maxim, City of Mercer Island • Alison Van Gorp, City of Mercer Island • Daniel Hubbell, City of Mercer Island

Mercer Island engaged with the community to rewrite a significant portion of its code. The session will focus on: A) what worked well; B) what could have been improved, C) lessons learned; and D) thoughts on the next effort. The panel discussion will represent both staff and Planning Commission's perspectives.

Grand Ballroom, Salon III ..... 1 CM

**11:00 – 11:15 am**

**BREAK & EXHIBITS**

Grand Ballroom, Foyer

**11:15 am – 12:00 pm**

**Intergovernmental Watershed Planning to Recover Salmon**

**SPEAKER:** Doug Osterman, MRP, AICP, King County

A coalition of 17 local governments in the Puget Sound region of Washington are using new science about the threats of stormwater, toxins, and climate change to inform land and water management and policy to stave off extinction of salmon.

Grand Ballroom, Salon I.....0.75 CM



## LAMIRDs: Comparing County Experiences

MODERATOR: Joseph Tovar, FAICP, William D. Ruckelshaus Center

SPEAKERS: Tamara Laninga, PhD, AICP, Western Washington University • Brian Kirk, Western Washington University • Clayton Williams, Western Washington University • Andrew Randall, Western Washington University • Jami Hayes, City of Post Falls

The presentation examines the Growth Management Act's LAMIRD provisions as applied in several Washington counties. It compares similarities and differences related to boundaries, land use, development standards, history of development, and zoning surrounding LAMIRDs. It concludes with a discussion of challenges, successes and future opportunities for LAMIRDs.

Spokane Falls A/B.....0.75 CM

## Minimizing the Attack Surface: Techniques for Land Use Planning Borrowed From Computer Science

SPEAKER: Ryan Walters, JD, Samish Indian Nation

Learn how to apply modern concepts from software code writing and the software industry to improve your development code and your delivery of planning projects.

Grand Ballroom, Salon III.....0.75 CM

## 12:10 pm – 1:30 pm

### AWARDS LUNCH

Grand Ballroom, Salon IV & V

## 1:45 pm – 3:00 pm

### Baby Steps to Vision Zero

SPEAKERS: Sarah Saviskas, AICP, Fehr & Peers • Justin Belk, PE, City of Tacoma • Matthew Enders, PE, WSDOT • Sean Messner, PE, Spokane County

This session will explore one avenue cities and counties can take to make progress on safety and qualify for external funding without diving into the Vision Zero deep end – creating a Local Road Safety Plan (LRSP). Session will cover LRSPs 101, lessons learned by jurisdictions, and LRSPs to Vision Zero.

Grand Ballroom, Salon I..... 1.25 CM

### Navigating Tricky Councils

Speakers: Kendra Breiland, AICP, Fehr & Peers • William Grimes, AICP, Studio Cascade • Lisa Grueter, AICP, BERK Consulting • Richard Weinman, JD, AICP, Weinman Consulting LLC

Planners move the needle, but do so slowly working with elected councils that have different values. How do we work in this context and recognize our own bias? This session will be a dialogue between the audience and four seasoned consultants who have practiced statewide in communities large and small.

Spokane Falls A/B ..... 1.25 CM

### New Rules for Schools: School Siting Challenges and Creative Solutions

MODERATOR: Anne Fritzel, AICP, Washington Dept of Commerce

SPEAKERS: Karen Wolf, FACIP, King County • Kateri Schlessman, AICP, Educational Service District 112 / Construction Services Group

Planning new schools to keep up with growth continues to be a challenge in our state. This session will provide an overview of recent amendments to the GMA to address this challenge, an overview of how school districts do their planning, and some examples of innovative approaches to fit schools into tighter spaces.

Grand Ballroom, Salon II..... 1.25 CM

**1:45 pm – 3:30 pm**

**Intro to Tribal Law for Planners**

It is imperative for city, county and state planner's to understand the basics of Federal Indian Law and tribal sovereignty in order to establish positive working relations with tribes. This session will cover tribal sovereignty, key Supreme Court cases that define the status of American Indian tribes in relationship to state authority, and examples of contemporary American Indian tribal planning.

Grand Ballroom, Salon III ..... 1.75 LAW CM

**1:45 pm – 4:30 pm**

**MOBILE WORKSHOP**

**Life in the Heart of the Rapids**

A walking tour of downtown Spokane housing, from historic Single Room Occupancy workforce housing to mixed-use buildings with luxury apartments.

Meet at Conference Registration Desk.....2.25 CM

**3:00 pm – 3:30 pm**

**BREAK & EXHIBITS**

Grand Ballroom, Foyer

**3:30 pm – 4:30 pm**

**Buildable Lands & Land Capacity Analysis: What's the Connection**

MODERATOR: Brandon Gonzalez, AICP, LDC, Inc.

SPEAKERS: Karen Wolf, FAICP, King County • Art Castle, Building Industry of Washington • Bryce Yadon, Futurewise

The Washington State Department of Commerce is completing an update to the Buildable Lands Program Guidelines. There are many important lessons that counties planning under the Review & Evaluation Program (Buildable Lands) can teach others, particularly on performing land capacity analyses for comprehensive plan updates. This session will explore a number of topics related to determining how much land and capacity are available for development from the diverse perspectives of building and environmental groups, as well as the jurisdictions performing the analyses. The session will be a unique chance to learn about the complex planning issues related to land capacity directly from those who are working to develop state guidelines.

Spokane Falls A/B..... 1 CM

Wi-Fi sponsored by: **FEHR & PEERS**

Network: DoubleTree Meeting

Password: FehrPeers

## Blue Mountain Region Trails Plan – A Regional Interconnected Non-Motorized Network

SPEAKERS: Elizabeth Chamberlain, AICP, City of Walla Walla • Andrea Weckmueller-Behringer, CISP, RAS, AICP, Walla Walla Valley Metropolitan Planning Organization • Mary Campbell, Community Council

In an unprecedented regional effort, more than 30 local, regional, state and federal stakeholder entities joined forces to develop a Blue Mountain Region Trails Plan that spans all involved jurisdictions in Columbia and Walla Walla counties and northeastern Umatilla County.

Grand Ballroom, Salon I..... 1 CM

## Planning for Spokane's South University District

MODERATOR: Michael Stringer, AICP, Maul Foster & Alongi, Inc.

SPEAKERS: Lars Gilberts, Spokane University District • Latisha Hill, Avista Development • Andrew Worlock, City of Spokane • Bill Grimes, AICP, SCJ Alliance

Years of planning and public investment have laid the foundation for revitalization of Spokane's University District. In this interactive session, participants will learn about how the University District has positioned for success and will have the opportunity to share their expertise to help shape its future.

Grand Ballroom, Salon II..... 1 CM

# Notes

---

---

---

---

---

---

---

---

---

---

---

---

---

---

---

---

---

---

---

---

---

---

---

---

---

---

---

---

---

---

---

---

# 2018 Planning Awards

## Celebrating Great Gathering Spaces

After successfully launching the *Great Places in Washington* program last year, which awarded two Great Neighborhoods, this year's program recognizes *Great Gathering Spaces in Washington State*. Awards this year were given to gathering spaces based on their relative size: SMALL (generally less than 10,000 square feet), MEDIUM (generally up to about an acre in size), and LARGE spaces (more than an acre).

Twenty gathering spaces were nominated and evaluated per the following criteria: Great gathering spaces must...

- Be mostly outdoors, open to the public and free of charge at least 12 hours a day
- Include a variety of functional attributes that encourage human contact and social activity for all age groups
- Feature definable boundaries while having good linkages to surrounding uses and areas
- Features design elements and architectural features that are visually interesting and contribute to the use and enjoyment of the space

## The Winners:

While the committee felt that all of these spaces were winners, four spaces rose to the top:

SMALL: Second Stree Plaza  
City of Langley & Framework

MEDIUM: Hing Hay Park  
City of Seattle & MIG  
Pike Place Marketfront  
City of Seattle, Pike Place Market PDA & Berger Partnership

LARGE: Eagle Harbor Waterfront Park  
City of Bainbridge Island & Walker Macy

## Great Places in Washington State



# New AICP Members!

Congratulations to Washington's newest AICP planners!

## November 2017 Exam

Michael Austin, AICP  
Malia Bassett, AICP  
Sonja Burseth, AICP  
Danielle Butsick, AICP  
Jason Garnham, AICP  
Heidi Gudde, AICP  
Hannah McIntosh, AICP  
Alan Peters, AICP  
Gabriel Philips, AICP  
Sarah Saviskas, AICP  
Matthew Stafford, AICP  
Nicole Stickney, AICP  
Elizabeth Underwood-  
Bultmann, AICP

## May 2018 Exam

Amanda Almgren, AICP  
Erin David, AICP  
Anna Dearman, AICP  
April Delchamps, AICP  
James DuBois, AICP  
Brandon Herman, AICP  
Daniel Kennedy, AICP  
Benjamin Madeo, AICP  
Jonathan Maland, AICP  
Mike McCarty, AICP  
Katrina Nygaard, AICP  
Colin Poff, AICP  
Colin Quinn-Hurst, AICP  
Nicholas Richter, AICP  
Jason Woycke, AICP

## May 2018 Exam – AICP Candidates

Neal Abbott,  
AICP Candidate  
Jonathan Ahn,  
AICP Candidate  
Bryanna Osmonson,  
AICP Candidate  
Annegret Nautsch,  
AICP Candidate

Wifi sponsored by: FEHR  PEERS

Network: DoubleTree Meeting

Password: FehrPeers

