



wicked problems 2013
SMART SOLUTIONS



**APA WA PLANNING
CONFERENCE**

OCTOBER 2-3, 2013
Meydenbauer Center
Bellevue, WA



SPONSORS

Gold Sponsors



Silver Sponsors



Department of Commerce
Innovation is in our nature.



Bronze Sponsors



WELCOME TO THE 2013 APA WASHINGTON ANNUAL CONFERENCE!

Welcome to the 2013 APA Washington Annual Conference! Our theme this year is *Wicked Problems Smart Solutions*. A wicked problem is one that can defy solution because of incomplete, contradictory, and changing conditions. In our program, we recognize the persistence and creativity of planners in coming up with smart solutions to wicked problems. You will find an inspiring array of new and innovative ideas, successful case studies, and lessons learned to help you with your own wicked problems.

With a downtown that has evolved into an attractive and lively urban center, we are fortunate to be meeting in Bellevue. Take advantage of our location to walk the downtown, including the park, the library, the transit center, and many other areas of interest. Looking for more? Here are a few ideas:

- Take a walking tour – some mobile workshop space may still be available
- Drop by the Conference's Opening Reception at the Bellevue Art Museum to connect with colleagues, hear some great music from the Nordmans, participate in the APA WA Student Scholarship Silent Auction and browse the Museum's exhibits
- Participate in the pub crawl following the Opening Reception
- Attend our Partners track to hear diverse perspectives at sessions led by professionals from the ULI, ASLA, and ITE.

We are very fortunate to have two outstanding plenary speakers this year in Mitchell Silver, AICP, Past President of APA and Ray Quay, FAICP, with the Global Institute of Sustainability at Arizona State University. At the Friday plenary session, we recognize the work of our peers at the APA/PAW Awards.

The conference committee has worked hard to provide a wide variety of interesting and relevant breakout sessions and mobile workshops, as well as opportunities to network with colleagues and exhibitors. We hope while you are here you are able to take advantage of the many opportunities to learn from experts in planning in the Northwest, to meet old friends and make new ones, and to explore Bellevue.

Welcome, and enjoy the conference!



Kendra Breiland, AICP
Conference Co-chair



Deborah Munkberg, AICP
Conference Co-chair

CONFERENCE COMMITTEE

CONFERENCE CO-CHAIRS

Deborah Munkberg, AICP
Kendra Breiland, AICP

PROGRAM CO-CHAIRS

Bob Bengford, AICP
Patrick Lynch, AICP

ADVISORY

Jill Sterrett, FAICP
Ivan Miller, AICP

SPONSORSHIP / EXHIBITORS

Michael Booth, AICP

SCHOLARSHIP/ SILENT AUCTION

Kell McAboy, AICP
Dan Burke, AICP CTP

MOBILE WORKSHOPS/HOST

Michael Kattermann, AICP

EVENT MANAGER

Stephanie Kennedy,
Total Event Connection

REGISTRATION MANAGER

Lori Servin, Action Registration

TABLE OF CONTENTS

Sponsors	2
Welcome Letter.....	3
Conference Committee	4
Meeting Room Map	5
Schedule at a Glance.....	6-7
Keynote Speakers	8
Mobile Workshops.....	9
Session Descriptions	10-16
Reception & Pub Crawl.....	17
WA APA Board of Directors.....	18
AICP Certification.....	19

MEETING ROOMS

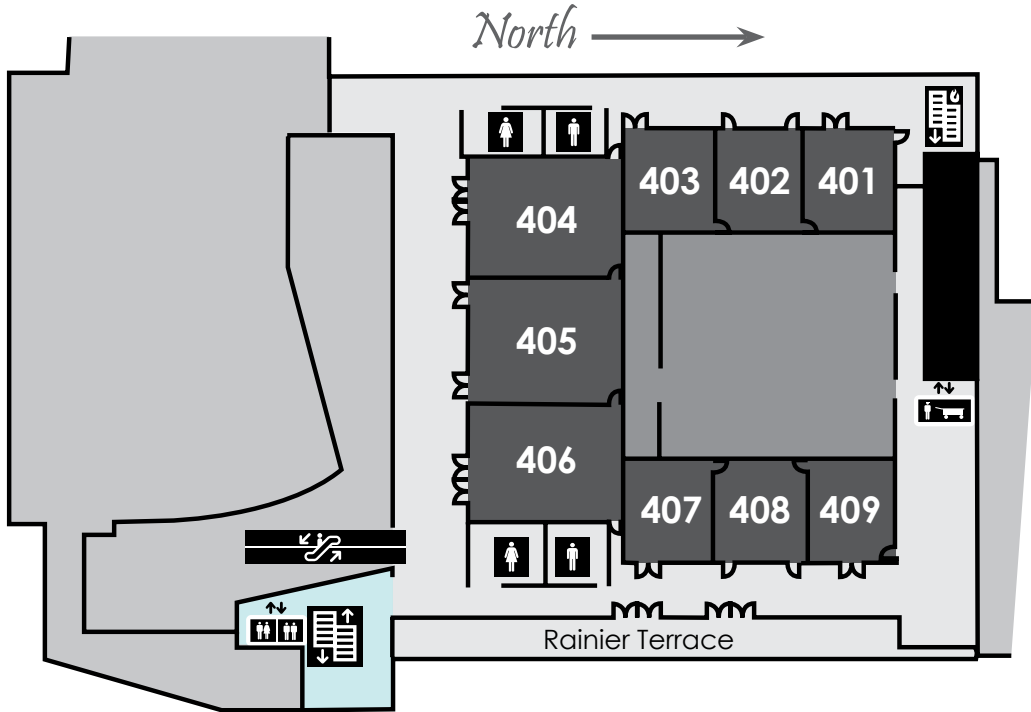

M MEYDENBAUER
CENTER

LEVEL 4 MEETING ROOMS

SCHEDULE AT A GLANCE

TRACK 1
Get Real Paid
Fiscal challenges &
economic vitality
ROOM 401

TRACK 2
Poker Face
Working with
multiple interests
ROOM 402

TRACK 3
Shuffle
Emerging issues
ROOM 403

TRACK 4
Transformer
Positive,
transformative
change
ROOM 407

TRACK 5
**We are the
World**
Social, health &
environmental
solutions
ROOM 408

TRACK 6
Partnerships
Collaborative
solutions
ROOM 409

TUESDAY, OCTOBER 1

7:00 am - 3:00 pm	YOUTH SUMMIT ON CLIMATE CHANGE
1:00 - 4:00 pm	Short Course on Local Planning
5:00 - 8:00 pm	APA WA Board Meeting

WEDNESDAY, OCTOBER 2

7:30 - 8:30 am	Registration, Networking and Exhibits					
8:30 - 10:00 am	OPENING SESSION: Planning for the New Reality • Mitchell J. Silver, AICP, Past President of APA (Room 404)					
10:00 - 10:30 am	AM Break with Exhibitors					
10:15 am - 12:15 pm	MOBILE WORKSHOP: The Art of Planning Art					
10:30 am - Noon	Transportation Impact Fees: Barriers or Benefits for Infill?	Planning in a Split Universe	GMA Planning Informed by Market Realities	Satisfaction: Triple Win Plans and Projects	Tools for Including Equity in Planning and Investment Decisions	Right Size Parking Project
12:15 - 1:30 pm	LUNCH & KEYNOTE SPEAKER: Ray Quay, FAICP (Room 404)					
1:30 - 3:00 pm	Shop Talk: Local Retail Planning	Development Review: Gray Areas, Shared Interests & Solutions	Installation Planning for the 21st Century	Growing Transit Communities on the Eastside	FIT & WELL – A Community Vision with a Focus on Health	Young Planners Group <i>(not submitted for CM credits)</i>
1:45 - 5:15 pm	MOBILE WORKSHOP: Transforming Suburbia - Eastside Style					
3:00 - 3:30 pm	PM Break with Exhibitors					
3:30 - 5:00 pm	There's No Place Like Work: Every-day Resources to Produce More with Less	Recipe for Success – Three Proven Ingredients	Bringing Together Diverse Interests to Enhance the Cascade Loop Experience	Municipal Sustainability Strategies "Mix Tape": A Compilation of Greatest Hits from Around the State	Safe Routes to School and Community Planning	Balancing Safety and Mobility on our Transportation Network
5:15 - 7:00 pm	RECEPTION / SILENT AUCTION • Bellevue Art Museum					
7:00 pm	PUB CRAWL					

TRACK 1 Get Real Paid Fiscal challenges & economic vitality ROOM 401		TRACK 2 Poker Face Working with multiple interests ROOM 402		TRACK 3 Shuffle Emerging issues ROOM 403		TRACK 4 Transformer Positive, transformative change ROOM 407		TRACK 5 We are the World Social, health & environmental solutions ROOM 408		TRACK 6 Partnerships Collaborative solutions ROOM 409			
THURSDAY, OCTOBER 3													
7:30 - 8:30 am		Registration, Networking and Exhibits											
8:30 - 10:00 am		Issaquah Case Study – Creating a Bold Vision and Planning for Implementation		Fostering Collaborative Solutions to Planning and Other Policy Challenges		Condominiums Versus Apartments: The True Story		Smart Streets: Complete + Artful + Livable		Creative Solutions to the Mitigation Puzzle		Creating Partnership Out of Controversy	
10:00 - 10:30 am		AM Break with Exhibitors											
10:30 am - Noon		Economic Doldrums? Historic Preservation has \$olution\$		Data: What's It Good For?		Too Much of a Good Thing?		Spandex Optional – Increasing Access to Bicycling in the Puget Sound Region		Mitigating Climate Change at the Local Level		Partnering with Landscape Architects	
12:15 - 1:30 pm		LUNCH: Annual PAW/APA Awards and Chapter Meeting (Room 404)											
1:30 - 3:00 pm		Making Sense of Development Agreements		LAW Developing a Unified Code for Marijuana Production, Processing and Retail Sales (Room 402)		MiMo is Historic: Planning Now to Preserve Your Mid-Century Modern Neighborhoods		Our Coastal Communities – How Can We Address Rising Tides?		ETHICS 101: It's Hard to be a Saint in the City (Room 408)		Can Planners Create Jobs? Understanding Roles in Economic Development	
3:00 - 3:30 pm		PM Break with Exhibitors											
3:30 - 5:00 pm		LAW Land Use Law in a Nutshell (Room 403)		TRACK 2: Success & Sustainability – Start Your Update on the Right Foot and Step Toward a More Sustainable Future		ETHICS How Did We Do? Conference Case Studies in Ethics (Room 408)		TRACK 5: Urban Ag in the Burbs (Room 409)					

KEYNOTE SPEAKERS

Planning for the New Reality

Mitchell Silver, AICP

Wednesday, October 2

8:30 am – 10:00 am



Emerging trends such as demographic shifts, climate change and a new focus on the economy, have brought both challenges and opportunities to the planning and

design professions. How are these trends reshaping our cities, our professions? This presentation will offer suggestions on how we can embrace a new reality of “planning for people”, not just “planning for place.”

Mitchell Silver is the Chief Planning and Economic Development Officer in the City of Raleigh, North Carolina. Silver is an award-winning planner with more than 25 years of planning experience. He is nationally recognized for his leadership in the profession and his contributions to contemporary planning issues.

Before coming to Raleigh in 2005 as planning director, Silver worked as policy and planning director in New York City, a principal of a New York City-based planning firm, a town manager in New Jersey and deputy planning director in Washington, D.C. He has taught graduate planning courses at Hunter College, Brooklyn College, Pratt Institute, and North Carolina State University. As planning director in Raleigh, he led the comprehensive plan update process. He is now overseeing a rewrite of the city’s Development Code.

Ray Quay, FAICP

Wednesday, October 2

12:15 pm – 1:30 pm



Anticipatory governance, a planning paradigm for high uncertainty, suggests we cannot predict the future but can anticipate a range of possible futures and identify actions to implement as the

future unfolds. This presentation examines anticipatory governance: uncertainty, anticipation, flexible planning actions, and a longer view of planning management / politics.

Ray Quay has been associated with Decision Center for a Desert City (DCDC) since 2004 as a stakeholder, advisor, and researcher. In his former position as an Assistant Director of the Water Services Department for the City of Phoenix, Ray was involved with DCDC in stakeholder outreach, water demand and heat island research, and in the application of climate change science and research to public adaptation policy and programs.

Ray joined DCDC in 2010 as an academic professional. His involvement now includes expanding the capabilities and facilitating the use of WaterSim as a research and public policy tool, expanding DCDC’s stakeholder outreach with water managers and land use planners, facilitating the initiation and development of academic research that is applicable to current and future public policy issues, and participating directly in various DCDC supported research.

Ray’s research interests include advanced scenario planning, anticipatory governance, climate change impacts and adaptation, water demand analysis and models, regional growth, and visualization of sustainability and uncertainty.

MOBILE WORKSHOPS

The Art of Planning Art

Wednesday, October 2

10:15 am – 12:15 pm

SPEAKER: Mary Pat Byrne, City of Bellevue

Art in all its forms is an important part of the physical, social and economic fabric of Bellevue and nowhere is that more evident than downtown. Take a guided walking tour of the public and private art that contributes to the sense of place and creates a truly urban experience. Learn about the importance of art and culture to Bellevue's economy and identity. Wear comfortable shoes and appropriate clothing for an urban hike!

Transforming Suburbia – Eastside Style

Wednesday, October 2

1:45 pm – 5:15 pm

SPEAKERS: Emil King, AICP, City of Bellevue; Jeff Churchill, AICP, City of Redmond; Gary Lee, City of Redmond; Ben Bakkenta, AICP, Puget Sound Regional Council; Paul Inghram, AICP, City of Bellevue

Light rail is coming to the Eastside cities of Bellevue and Redmond. Visit existing and planned transit-oriented development sites in various future station areas, including the Downtown Bellevue metropolitan center and rapidly evolving Downtown Redmond. Learn about the planning and community engagement that has occurred at the local level, as well as the complementary Growing Transit Communities Partnership led by the Puget Sound Regional Council. The tour will include bus transport and short walks/presentations in Downtown Bellevue and Redmond.

SESSION DESCRIPTIONS

WEDNESDAY, OCTOBER 2

8:30 - 10:00 am

404

Planning for the New Reality

SPEAKER: Mitchell Silver, AICP, City of Raleigh, NC

Emerging trends – demographic shifts, climate change and a new focus on the economy – have brought both challenges and opportunities to the planning and design professions. How are these trends reshaping our cities, our profession? The presentation will offer suggestions on how we can embrace a new reality of “planning for people”, not just “planning for place.”

CM 1.5

10:30 - 12:00 pm

401

TRACK 1:

Transportation Impact Fees: Barriers or Benefits for Infill?

MODERATOR: Larry Toedtli, PE, Transpo Group
SPEAKERS: Chris Comeau, AICP, City of Bellingham Public Works; Ryan Lopossa, PE, City of Vancouver; Louis Meuler, City of Spokane

Transportation Impact Fees (TIFs) are typically perceived as either “barriers” or “give-aways” to development. This begs the question “How should the cost of infrastructure needed to support growth be paid for and by whom?” Come hear some innovative answers to this question.

CM 1.5

402

TRACK 2:

Planning in a Split Universe

MODERATOR: Mindy Black, LEED AP BD+C, Weber Thompson
SPEAKERS: Gary Prince, King County Metro Transit; Janice Coogan, City of Kirkland; Paul Inghram, AICP, City of Bellevue

This panel discussion identifies challenges confronting a public transit agency in expanding an existing park and ride and creating transit oriented housing on a property spanning a jurisdictional boundary. Jurisdictional agency representatives summarize how separate comprehensive plans, zoning and development objectives were combined to support a transit oriented development.

CM 1.5

403

TRACK 3:

GMA Planning Informed by Market Realities

MODERATOR: Kapena Pflum, AICP, BERK
SPEAKERS: Mark Personius, AICP, Whatcom County Planning & Development Services; Eric Baker, Kitsap County; Salina Lyons, AICP, City of Covington

The economic cycle brings inevitable highs and lows, as demonstrated by the mid-2000s housing bubble and subsequent economic downturn. This panel discussion will focus on how data-driven market trend analysis can inform GMA planning and help align plans with market realities.

CM 1.5

407

TRACK 4:

Satisfaction: Triple Win Plans and Projects

SPEAKERS: Peter Hurley, Sustainable Transportation Council; Chris Breiland, PE, Fehr & Peers

Can't get no “Satisfaction?” Learn how to use a “triple win” methodology for setting targets, evaluating alternatives and making decisions to optimize the economic, environmental and social performance of transportation plans and projects. The Sustainable Transportation Analysis and Rating System, STARS, is being used by agencies in California, Oregon and Washington.

CM 1.5

408

TRACK 5:

Tools for Including Equity in Planning and Investment Decisions

MODERATOR: Jason Reece, AICP, Kirwan Institute for the Study of Race and Ethnicity
SPEAKERS: Rachel Miller, MAKERS; Matthew Martin, Kirwan Institute for the Study of Race and Ethnicity; Tim Parham, AICP, Puget Sound Regional Council

This session explores “opportunity mapping” and the STAR Community Rating System for assessing and understanding access to opportunity. Using Puget Sound case studies, the presenters show how data-based evaluations can inform fair housing, transportation, and health policies, and help to explain relationships between the built environment and social equity.

CM 1.5

409

TRACK 6:
Right Size Parking Project

MODERATOR: Rick Williams, Rick Williams Consulting
 SPEAKERS: Audrey Church, Diamond Parking; Tracy Edgers, Union Bank

A panel of development and planning professionals will discuss their collaboration to identify new parking requirements to make residential development more affordable. The session will discuss ways to remove barriers to developing housing in dense urban areas. This session discusses solutions to wicked problems related to provision of affordable housing.

CM 1.5

12:15 - 1:30 pm

404

Lunch and Keynote Address

SPEAKER: Ray Quay, FAICP, Global Institute of Sustainability

Anticipatory governance, a planning paradigm for high uncertainty, suggests we cannot predict the future but can anticipate a range of possible futures and identify actions to implement as the future unfolds. This presentation examines anticipatory governance: uncertainty, anticipation, flexible planning actions, and a longer view of planning management / politics.

CM 0.5

1:30 - 3:00 pm

401

TRACK 1:
Shop Talk: Local Retail Planning

SPEAKERS: Chris Hugo, AICP, City of Sequim; Jennifer Gerend, AICP, Evergreen State College; Chris Mefford, AICP, Community Attributes

Retail planning is high stakes: design, amenities, traffic, and sales tax revenues motivate our actions – often competitively between municipalities. How are communities planning for retail amidst changing economic realities around the cost, type, and supply of retail space? What can research tell us? Learn about proactively guiding local retail economies.

CM 1.5

402

TRACK 2:
Development Review:
Gray Areas, Shared Interests & Solutions

MODERATOR: Bob Bengford, AICP, MAKERS
 SPEAKERS: Eric Shields, AICP, City of Kirkland; Liz Stead, LEED AP, BD+C, City of Bellevue; David R. Burns, AICP, City of Lacey

Reviewing development applications for compliance with zoning and design guidelines can be very challenging even with the most thorough, well written provisions. Planners will discuss development review case studies – describing the challenges, the decision and how they came about it, what was ultimately built, and lessons learned along the way.

CM 1.5

403

TRACK 3:
Installation Planning for the 21st Century

SPEAKERS: Stefani Wildhaber, AIA, MAKERS; Brent Huizingh, AICP, MAKERS; Michael Austin, MAKERS

This session seeks to identify new strategies for installation master planning, which have resulted in both unique and dynamic opportunities for both installation stakeholders and planners working in the surrounding communities.

CM 1.5

407

TRACK 4:
Growing Transit Communities on the Eastside

MODERATOR: Mandi Roberts, AICP, Otak, Inc.
 SPEAKERS: Paul Inghram, AICP, City of Bellevue; Mary Pat Lawlor, Puget Sound Regional Council; Lori Peckol, AICP, City of Redmond

Transforming Eastside high capacity transit station areas into vibrant, equitable, transit-oriented neighborhoods is at the heart of the East Corridor Implementation Support project. This interactive panel discussion will present the full range of strategies and tools being explored to address this need.

CM 1.5

AIC P Certification Maintenance Credits requested for each session.

408

TRACK 5:

Fit and Well – A Community Vision with a Focus on Health

MODERATOR: Anne Fritzel, AICP, Washington State Department of Commerce
 SPEAKERS: Amy Pow, MCIP, Tacoma-Pierce County Health Department; Julia Walton, AICP, Inova Planning Communications Design LLC.; Katie Baker, AICP, City of Puyallup

This session offers a web-based toolbox solution to address “what planners should and can do to build healthy communities fostering physical and mental wellness”. Presenters will define built environment and healthy community outcomes supporting Vision 2040; introduce planning process and policy intervention tools; and share lessons of applying the toolbox.

CM 1.5

409

TRACK 6:

Young Planners Group

MODERATOR: Salina Lyons, AICP, City of Covington
 SPEAKERS: Jeff Aken, Cascade Bicycle Coalition; Becky Bicknell, Bellwether Housing; Michael Booth, Jacobs North America; John Davies, RTC Transportation Consulting; Corbitt Loch, AICP, City of Lynnwood; Clay White, Snohomish County

In this interactive session, six experienced planning professionals from the public, private and non-profit sectors will talk with participants about what they wish they knew when they started their careers. Discussion topics will include: lessons learned the hard way, strategies for overcoming common job challenges; and skills and practices that lead to success in the workplace. Information about the Puget Sound Section’s Young Planners Group and the services that they offer will also be provided.

CM Not submitted for CM credits

3:30 - 5:00 pm

401

TRACK 1:

There’s No Place Like Work: Everyday Resources to Produce More with Less

MODERATOR: Jennifer Henning, AICP, City of Renton
 SPEAKERS: Kristina Cerise, AICP, Van Ness Feldman; Erika Conkling, AICP, City of Renton

We’re not in Kansas anymore – demands are high but staffing is low. Thankfully, cognitive and behavioral science wizards have discovered simple secrets to increasing employee productivity, creativity and satisfaction. You may be surprised to find that the answers you need have been there the whole time: YouTube, walking shoes and silence...oh my!

CM 1.5

402

TRACK 2:

Recipe for Success – Three Proven Ingredients

MODERATOR: Andy Padvorac, AICP, Puget Sound Energy
 SPEAKERS: Kristine Edens, AICP, EnviroIssues; Steven Fischer, City of Redmond; Karissa Kawamoto, AICP, HDR Engineering

Most of the easy projects have already been done, so what does that leave? Challenges! As planners, we are also challenged to find innovative and more efficient ways to tackle difficult projects. Hear from three panelists about proven permitting, public outreach, and mitigation solutions.

CM 1.5

403

TRACK 3:

Bringing Together Diverse Interests to Enhance the Cascade Loop Experience

SPEAKERS: Mandi Roberts, AICP, Otak, Inc.; Susan Driver, AICP, Town of Entiat; Annette Pitts, Cascade Loop Association

The Cascade Loop represents the best of Washington as a unique cross-state travel experience. Planning for the long term sustainability and enhancement of this experience has required engagement of diverse interests through a variety of innovative methods, which will be highlighted in this session.

CM 1.5

407

TRACK 4:

Municipal Sustainability Strategies “Mix Tape” – A Compilation of Greatest Hits from Around the State

MODERATOR: Andrea Lewis, LEED AP, O’Brien & Company
 SPEAKERS: Mike Smith, City of Ellensburg; Ellen Miller-Wolfe, Economic Development Manager; Miranda Redinger, City of Shoreline

How can cities best approach integrating sustainability into the existing web of their various plans and policies? Hear from the cities of Sammamish, Shoreline and Ellensburg about their process and how they turned community challenges into opportunities to create, implement and track a meaningful sustainability plan.

CM 1.5

AIC P Certification Maintenance Credits requested for each session.

408

TRACK 5:

Safe Routes to School and Community Planning

MODERATOR: Sarah Butzine, OSPI
 SPEAKERS: Charlotte Claybrooke, Washington State Department of Transportation; Seth Schromen-Wawrin, Bicycle Alliance of Washington

Schools are an important player in realizing planning goals. Learn strategies to develop a mutually supportive collaboration with schools using best practices from Washington State. Particular focus will be on the Safe Routes to School program, a nationally recognized movement to encourage youth to walk and bike to school.

CM 1.5

409

TRACK 6:

Balancing Safety and Mobility on Our Transportation Network

MODERATOR: Jim Ellison, PE, Traffic Engineering Consultant, Past President of the Institute of Transportation Engineers (ITE) Washington Section
 SPEAKERS: Gary Norris, PE, DN Traffic Consultants, ITE Washington Section – Safety Committee Co-Chair; Matt Beaulieu, PE, WSDOT, ITE Washington Section – Traffic Simulation Roundtable Co-Chair; Dongho Chang, PE, City of Seattle, ITE Washington Section – Current President

Washington State has an ambitious plan to have zero fatal collision by 2030. Improving safety on our roadways while maintaining efficient transport of people and goods is a wicked problem that requires smart solutions. Learn about some smart solutions that use our existing roadways in safer and more effective manner.

CM 1.5

THURSDAY, OCTOBER 3

8:30 - 10:00 am

401

TRACK 1:

Issaquah Case Study – Creating a Bold Vision and Planning for Implementation

MODERATOR: Erik Rundell, BERK
 SPEAKERS: Morgan Shook, AICP, BERK; Trish Heinonen, AICP, City of Issaquah; Taylor Carroll, Forterra

Join individuals from the public, private, and non-profit sectors as they discuss the development of the Central Issaquah Plan and how to promote economic vitality and more sustainable communities while addressing the fiscal and economic issues almost all jurisdictions are facing in the new normal following the Great Recession.

CM 1.5

402

TRACK 2:

The William D. Ruckelshaus Center: Fostering Collaborative Solutions to Planning and Other Policy Challenges

MODERATOR: Michael Kern, William D. Ruckelshaus Center
 SPEAKERS: Michael Gaffney, Governmental Studies and Services; Jim Kramer, Kramer Consulting; Amanda Murphy, William Ruckelshaus Center, Washington State University

The mission of the UW/WSU Ruckelshaus Center is to foster collaborative public policy in the state and region. This panel will introduce the Center and several important planning-related projects. The Center's Director and project facilitators will discuss project outcomes, similarities and differences, keys to success, and lessons learned.

CM 1.5

403

TRACK 3:

Condominiums Versus Apartments: The True Story

MODERATOR: Corbitt Loch, AICP, City of Lynnwood
 SPEAKERS: Alan Wallace, JD, Williams Kastner; Matthew J. D. Gardner, NABE, Gardner Economics;

Why are so few of the new multifamily dwellings being built as condominiums? What are the legal, liability, and socio-economic differences between condominiums and apartments? Are condominiums buildable now in Washington? Industry experts will deliver the condominium facts you crave.

CM 1.5

407

TRACK 4:

Smart Streets: Complete + Artful + Livable

MODERATOR: Kendra Breiland, AICP, Fehr & Peers
 SPEAKERS: Doreen Gavin, PE, LEED AP, AHBL; David Godfrey, PE, City of Kirkland; Nikole Coleman-Porter, AICP, City of Des Moines

We will provide real-world examples of how communities are retooling their streetscapes to achieve more desirable outcomes, including economic vitality, increased physical activity, safer streets, and consistency with sustainability goals. Recognizing that there is no one-size-fits-all, we will highlight case studies from a variety of facilities, both big and small.

CM 1.5

408

TRACK 5:

Creative Solutions to the Mitigation Puzzle

SPEAKERS: Suzanne Tomassi, The Watershed Company; Sky Miller, PE, The Watershed Company; Mike Kaputa, AICP, Chelan County

New and innovative tools for compensatory environmental mitigation will be presented. The techniques include in-lieu fee programs, conservation banking, natural resource damage banking, and other off-site approaches. Use of the methods will be presented from the points of view of planners, applicants, and regulators.

CM 1.5

409

TRACK 6:

Creating Partnership Out of Controversy

MODERATOR: Michael Kattermann, AICP, City of Bellevue
SPEAKERS: Mary Kate Berens, City of Bellevue; Ron Lewis, Sound Transit; David Berg, PE, City of Bellevue

A collaborative process between Sound Transit and Bellevue overcame obstacles to light rail. The partnership improved communication by engaging multiple disciplines from both agencies to analyze options, resolve challenges, and achieve a mutually acceptable alignment. Speakers will offer perspectives on how well the process achieved the objectives.

CM 1.5

10:30 - 12:00 pm

401

TRACK 1:

Economic Doldrums?

Historic Preservation has \$olution\$

MODERATOR: Greg Griffith, AICP, Washington State Department of Archaeology and Historic Preservation
SPEAKERS: Nicholas Vann, ALA, Washington State Department of Archaeology and Historic Preservation; Sarah Hansen, Washington Main Street

Coming out of the recession, communities are examining approaches to growth and development that applies lessons learned from previous boom and bust cycles. This includes giving a second look at making the most of our existing built environment. In this session, panelists will discuss historic preservation tools that conserve resources, foster healthy lifestyles, generate jobs, and support local businesses, all by capitalizing on assets of the historic built environment.

CM 1.5

402

TRACK 2:

Data: What's It Good For?

MODERATOR: Patrick Lynch, AICP, Transpo Group
SPEAKERS: Michael Hintze, AICP, Toole Design Group; Chris Comeau, AICP, City of Bellingham; Paula Reeves, AICP, CTP, Washington State Department of Transportation; Adam Parast, EIT, Transpo Group

Agencies are searching for more data-driven and analytical processes for prioritizing, validating, and maximizing return of investments for non-motorized transportation improvements. For this to happen, new methods of data collection, organization, and analysis are becoming increasingly important. Presenters will discuss methods for collecting data and how this data can be used.

CM 1.5

403

TRACK 3:

Too Much of a Good Thing: Approaches to Rating Sustainability and Assessing Performance

SPEAKERS: Justus Stewart, ENV-SP, O'Brien & Company; Brice Maryman, ASLA, LEED AP, SvR Design; Elizabeth Powers, LEED AP, O'Brien & Company; Jeralee Anderson, Ph.D., P.E., LEED AP, GreenRoads

How do you measure the sustainability of an infrastructure project or landscape? This session compares leading regional and national rating systems including: Greenroads, ENVISION, custom rating systems developed by jurisdictions, and more. In the second half, participants will get hands-on practice applying the right rating system to hypothetical projects.

CM 1.5

407

TRACK 4:

Spandex Optional – Increasing Access to Bicycling in the Puget Sound Region

MODERATOR: Jeff Aken, Cascade Bicycle Club
SPEAKERS: Kevin O'Neill, AICP, Seattle Department of Transportation; Joel Pfundt, AICP, CTP, City of Redmond; Holly Houser, Puget Sound Bike Share

This session will focus on increasing the attractiveness and access of bicycling to a broader audience than just the "lycra" crowd. Speakers will focus on planning and programming efforts to encourage a much broader segment of the population to use bicycles for daily and local trips.

CM 1.5

AIC P Certification Maintenance Credits requested for each session.

408

TRACK 5:

The Cool Planning Handbook – Mitigating Climate Change at the Local Level

SPEAKERS: Mandi Roberts, AICP, Otak, Inc.; Pete Sullivan, City of Redmond; Miranda Redinger, City of Shoreline

How Cool is Your Town? This session will highlight strategies and tools from the award-winning Cool Planning Handbook and engage participants in a dialogue about climate change mitigation and adaptation activities occurring throughout the region.

CM 1.5

409

TRACK 6:

Partnering with Landscape Architects

SPEAKERS: Don Benson, ASLA, AICP, Washington Chapter of ASLA; Colie Hough-Beck, ASLA; Jerry Coburn, ASLA

Explores the collaborative process between Landscape Architects and Planners. The objective will be to describe the profession of Landscape Architecture, show how Landscape Architects and Planners have worked on past projects and educate planners on how current trends and innovative practices in Landscape Architecture can offer opportunities for future collaboration.

CM 1.5

12:15 - 1:30 pm

404

Lunch, APA/PAW Awards and Chapter Meeting

1:30 - 3:00 pm

401

TRACK 1:

Making Sense of Development Agreements

MODERATOR: Scott Greenburg, AICP, City of Mercer Island
SPEAKERS: Jack Pace, City of Tukwila; Michael Walter, Keating, Bucklin & McCormack, Inc., P.S.; G. Richard Hill, University of Washington Law School

As we seek ways to use land more efficiently, development agreements have become a valuable tool in the planner's toolkit. The session will focus on the legal basis for development agreements and best practices in applying a development agreement to projects of varying scope, type and complexity.

CM 1.5

402

LAW

Developing a Unified Code for Marijuana Production, Processing and Retail Sales

MODERATOR: Ted Hunter, JD, Sound Law, LLC
SPEAKERS: Hilary Bricken, JD, Harris & Moure, PLLC; Angela Belbeck, JD, Ogden, Murphy, Wallace, PLLC

Are you ready with a code to address recreational marijuana? The state has developed regulations and licensing requirements for production, processing and retail sales. Planning Departments can take steps now. We will discuss sample codes and processes being put into place by pro-active jurisdictions.

CM 1.5

403

TRACK 3:

MiMo is Historic: Planning Now to Preserve Your Mid-Century Modern Neighborhoods

MODERATOR: Greg Griffith, AICP, Washington State Department of Archaeology and Historic Preservation
SPEAKERS: Nicholas Vann, AIA, Washington State Department of Archaeology and Historic Preservation; Michael Houser, Washington State Department of Archaeology and Historic Preservation

Bellevue is the perfect setting to learn about emerging historic preservation trends that take a close look at the historic and architectural significance of subdivisions, apartments, and shopping centers that influenced the face of our post World War II landscape. This session will revisit the architectural and planning trends from the post war era. Speakers will also examine the implications for planners in jurisdictions that are facing redevelopment pressures on mid-20th Century neighborhoods. Finally, we discuss tools and tips for documenting and preserving classic designs from the "recent past."

CM 1.5

407

TRACK 4:

Our Coastal Communities – How Can We Address Rising Tides?

MODERATOR: Nicole Faghin, LEED AP, Washington Sea Grant
SPEAKERS: Bob Freitag, CFM, Institute for Hazards Mitigation Planning and Research; Jamie Mooney, Washington Sea Grant; Bibbak Talebi, Department of Ecology; Linda Lyshall, San Juan Islands Conservation District

Increased storm events and rising tides from climate change mean that we need to think different about our coastal communities. Learn about tools and techniques to assess vulnerabilities, develop adaptation strategies and implement adaptation plans from experts in the field of coastal resiliency planning.

CM 1.5

408

TRACK 5:

Ethics 101 – It’s Hard to be a Saint in the City

MODERATOR: Joseph W. Tovar, FAICP, Consultant
 SPEAKERS: Joseph W. Tovar, FAICP, Consultant; Deborah Munkberg, AICP, Studio 3MW

This session helps planners recognize ethical dilemmas they may encounter and illustrates how the AICP Code of Ethics provides guidance for ethical actions. Scenarios drawn from real world experiences help illustrate ethical principles and practices.

CM 1.5

409

TRACK 6:

Can Planners Create Jobs?

Understanding Roles in Economic Development

SPEAKER: George Rolfe, Runstad Center for Real Estate Studies

How can urban planners improve the effectiveness of available economic development tools and evaluate economic development outcomes? This session will explore available tools, propose appropriate metrics for measuring effectiveness, and examine the role of planners, citizen activists, elected officials, and people representing business interests in implementing economic development and job creation programs.

CM 1.5

3:30 - 5:00 pm

403

LAW

Land Use Law in a Nutshell

SPEAKERS: Ted Hunter, JD, Attorney; Kristen Larson, Sound Law Center

This session covers the key concepts and cases involved in land use development in Washington State, including the GMA, SMA, SEPA, Subdivision Review, Vested Rights, Non-conforming Uses, and LUPA. The blend of politics and law is discussed as specific cases are reviewed in a fun and friendly manner.

CM 1.5

407

TRACK 2:

Success & Sustainability

SPEAKERS: Dave Andersen, AICP, Department of Commerce, Growth Management Services; Andrew (Andy) Lane, Esq., Cairncross & Hempelmann; Ikuno Masterson, LEED AP, AICP, ESA

This session will review legal and practical lessons learned from the last round of GMA periodic updates and include practical advice to assure your update starts and ends smoothly. Ways in which your community can include sustainability principles in your update process will also be explored.

CM 1.5

408

ETHICS

How Did We Do?

Conference Case Studies in Ethics

MODERATOR: Paul Inghram, AICP, City of Bellevue
 SPEAKERS: Mandi Roberts, AICP, Otak, Inc.; Chris Mefford, AICP, Community Attributes; Julia Walton, AICP, Studio 3MW; Kendra Breiland, AICP, Fehr & Peers; Greg Griffith, AICP, State Historic Preservation Office

This session recaps and evaluates case studies from the conference through an ethics lens. The aspirational section of the AICP Code of Ethics describes our primary obligation as serving the public interest and achieving high standards of integrity, proficiency, and knowledge. Come hear how that standard is applied in these real-life cases.

CM 1.5

409

TRACK 5:

Urban Ag in the Burbs

SPEAKERS: Kara Martin, Urban Food Link; Janet Shull, CSBA, LEED Green Associate, AICP, City of Federal Way; Becca Meredith, Research Ecologist

Across the country municipalities are adopting "urban agriculture" policies and regulations in response to their communities increasing interest in local food. Come learn about an analysis of relevant policies of Puget Sound communities and Federal Way's experience in adopting supportive policies and the community's role in making it happen.

CM 1.5

AIC P Certification Maintenance Credits requested for each session.

RECEPTION & PUB CRAWL

WEDNESDAY, OCTOBER 2

RECEPTION & SILENT AUCTION

Join us from 5:15 – 7:00 pm at the Bellevue Art Museum for food, drink, music, silent auction fundraiser, and exploring the main exhibit of Pacific Northwest artist Patti Warashina. Warashina's tremendous, unparalleled contributions to the world of ceramics with a retrospective of over 120 works spanning a 50-year career is highlighted in this exhibit. Warashina is known for her curiosity, effervescence, and healthy dose of skepticism. Her themes of human condition, feminism, car-culture, and political and social topics are raised by staying tuned-in to current news reports and her own subconscious voice. See more at: <http://www.bellevuearts.org/exhibitions/current>

PUB CRAWL

The pub crawl will depart from the Bellevue Art Museum. Join us for this annual event of networking and camaraderie while enjoying three Bellevue establishments. We will be visiting Rock Bottom Brewery, Palomino and ending the night at Parlor Billiards & Spirits. We look forward to seeing you there!



The WASHINGTON CHAPTER of the AMERICAN PLANNING ASSOCIATION is an organization of people with an interest in land use, housing, transportation, environmental, economic and social planning. Among others, our membership includes citizen planners, planning commissioners and other planning officials, and professional planners within the State of Washington and elsewhere.

BOARD of DIRECTORS

President	Ivan Miller, AICP
Vice President	Laura Hudson
Secretary	Chris Comeau, AICP
Treasurer	Bill Mandeville, AICP
Past-President	Jill Sterrett, FAICP
Columbia Section	Gary Mabley, ACIP
Inland Empire Section	Len Zickler, AICP
Northwest Section	Jennifer Aylor, AICP
Peninsula Section	Jim Rogers
Puget Sound Section	Salina Lyons, AICP
Southwest Section	Gary Albrecht, AICP

STANDING COMMITTEES

Annual Conference	Kendra Brieland, AICP Deborah Munkberg, AICP
Awards	George Steirer, AICP
Communications	Stacey Smith Kim Selby, AICP Robin McClelland, FAICP
Community Planning Assistance Team	Bob Bengford, AICP
Continuing Education	Susan Winchell, AICP
Legislative Action	Josh Peters, AICP Esther Larsen
Membership	Ferdouse Oneza, AICP
Planning Official Development Officer	Ryan Windish, AICP
Professional Development Officer	Nancy Eklund, AICP
Scholarship	Gabe Snedeker, AICP Tirrell Black, AICP
Tribal Planning	Michael Cardwell, AICP
UW Student Representative	Abigail Weber
EWU Student Representative	Bryan Esmeralda



**Certification
Maintenance**

How can I earn CM credits?

The American Planners Association (APA) (www.planning.com) and the Washington chapter (www.washington-apa.org) have extensive information on activities that qualify for CM credit. CM credit hours requested for sessions at this conference are pending.

How can I log CM credits?

Every AICP member has a personal online CM log. Use your APA ID and password to log in at www.planning.org, search for CM activities, rate them, and submit them to your CM log. CM credit has been requested for the majority of workshops and sessions at this conference unless noted. If you have questions, please contact APA at aicpcm@planning.org.

CONGRATULATIONS NEW AICP MEMBERS!

2012 AICP Exam

Jeff Abalos, AICP
 Kathleen Baker, AICP
 Lauren Balisky, AICP
 Angie Brewer, AICP
 Amalia Cody, AICP
 John Coleman, AICP
 Thomas Colleran, AICP
 Kevin Cricchio, AICP
 John Donahue, AICP
 Tim Gates, AICP
 Carolyn Johnson, AICP
 Wesley Kirkman, AICP
 James McHendry, AICP
 Kell McAboy, AICP
 Valerie Smith, AICP
 Joel Soden, AICP
 Orion Stewart, AICP
 Kathleen Weinand, AICP

2013 AICP Exam

Nathaniel Barnett, AICP
 Christopher Beale, AICP
 Nicholas Bond, AICP
 Jessica Davenport, AICP
 Matthew Herrera, AICP
 Mitchell Hooper, AICP
 Timothy Locke, AICP
 Kapena Pflum, AICP
 Erik Rundell, AICP
 Melissa Sartorius, AICP
 Morgan Shook, AICP
 Ardele Steele, AICP
 Victor Stover, AICP

Certified Transportation Planner

Joel Pfundt, AICP CTP
 Paula J. Reeves, AICP CTP

Certified Environmental Planner

Jacquelyn Lynch, AICP CEP

AICP Fellow

Mark Kulaas, FAICP

